

## Application

The SSR-845 extruded aluminum sunshade is designed to provide distinctive style to a building's exterior while keeping the building cool and saving energy by reducing glare and thermal load. It is ideal for sustainable or 'green' building construction. The SSR-845 is available in a wide array of anodized and painted finishes including custom color matching.

## Standard Construction

**Material:** Mill finish 6063-T5 extruded aluminum.

**Outrigger:** 8" high x 0.250" thick (203 x 6.4) plate with flat front.

**Blades:** 0.125" thick (3.2) thick rectangular tube style.

**Fascia:** 8" x 2" x 0.125" thick (203 x 51 x 3.2) rectangular tube.

**Minimum Size:** 12" (305) wide.

**Maximum Size:** Single section: 96" (2438) wide.  
 Multiple section: Unlimited

**Projection:** 24" (610), 36" (914), 42" (1067), 48" (1219), and 60" (1524).

**Mounting Bracket:** Exposed.

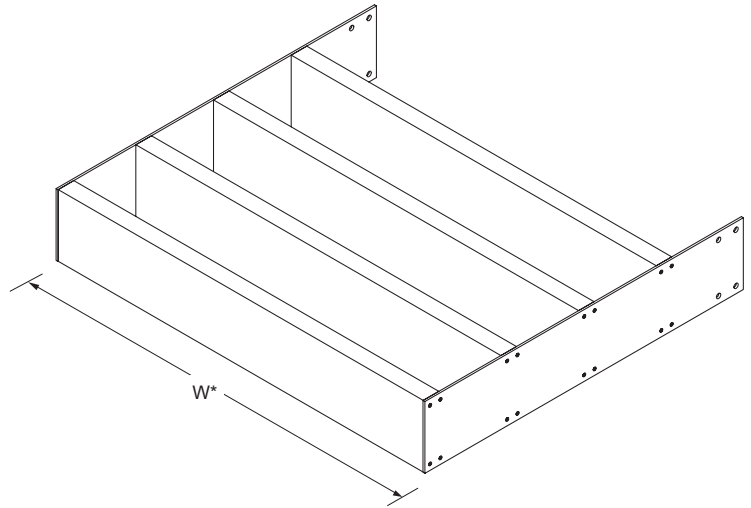

### Model **SSR-845**

(standard)

\*Dimensions furnished net O.D.  
 (Centerline of mounting bracket to centerline of mounting bracket).

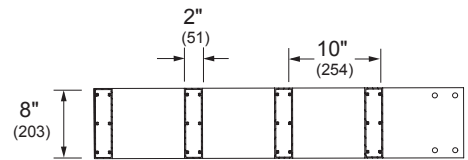

**Horizontal Section**

## Options

Factory finish:

- High Performance Fluoropolymer - 100% resin Newlar®/ 70% resin Kynar®
- Baked Enamel
- Clear Anodize
- Integral Color Anodize

- Tapered (top and bottom) outrigger.
- Concealed mounting bracket.
- Strut connection.
- Shroud connection.
- 90° corner.

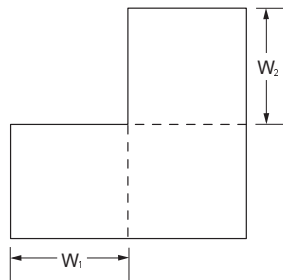

**90° Corner**

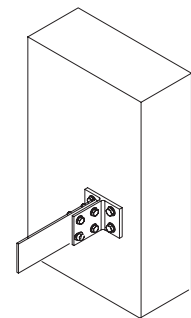

**Exposed Mounting Bracket**  
(standard)

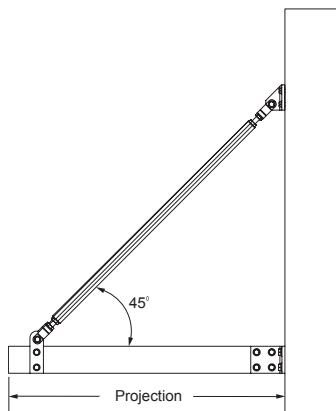

**Shroud Connection**  
(optional)

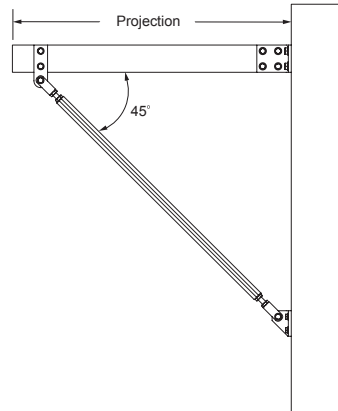

**Strut Connection**  
(optional)

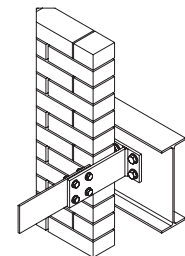

**Concealed Mounting Bracket**  
(optional)

Extruded Aluminum Sunshade **ASSR-845** (1/1) June 2009